

25
SNOWBOARDS

26





25
26

Gnu
SNOWBOARDS

The futuristic American board building legacy unleashes Facts and Fiction at sensational prices! Advanced geometry and technology upgrades for a double dose of shreddin. Wagyu beefy freestyle boarding from Cannon and crew. Bailey is our beautiful boss.

Jamie A shreds into the year of the snake. Warbs DIY's his finest Finest. Pro Mag power freeriding gets genetically modified...

Temp and Cannon's Banked Country and Barrett's Barrett...

We handmade delicious Gnu's for you family style.

**GWOOSH
INTO**



25 | *Gnu* | **26**
SNOWBOARDS

WE BUILD OUR OWN DAMN BOARDS.



TIM

Mervin
Gnu
SNOWBOARDS





BEAUTIFUL CHOICE



Hand Built in Washington State
WE BUILD OUR OWN DAMN BOARDS

ECO MATERIALS

- FSC CERTIFIED ECO WOODS
- LOW VOC RESIN SYSTEMS
- BIO TOP SHEETS

ECO PROCESS

- WATER BASED SUBLIMATION
- WATER BASED SOLVENTS
- WATER CLEANSSED FINISHING SYSTEMS
- NO TOXIC LACQUER COATINGS

ECO POWER

- WIND POWER
- WATER POWER

ECO RECYCLING

- WOOD SAWDUST TO SOIL
- RECYCLED WOOD
- RECYCLED PLASTICS

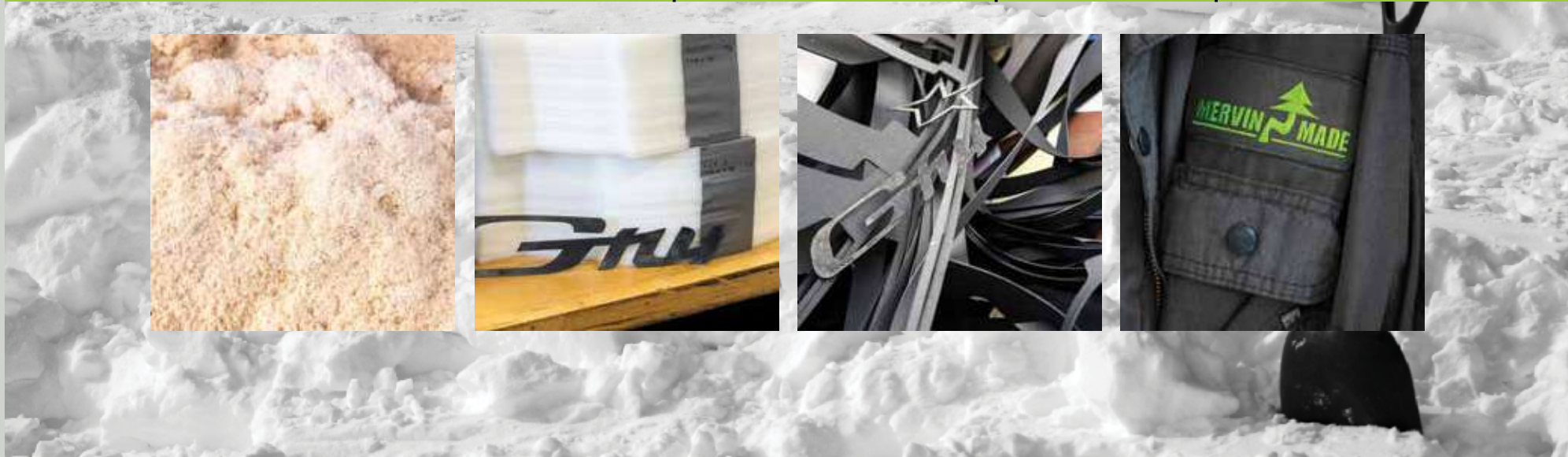

GNU SCIENCE

GNU EDGE HOLD ADVANTAGE



THE ORIGINAL SERRATED STEAK KNIFE TECHNOLOGY



A CUMMINS FAMILY EXCLUSIVE TEETH IN THE TAIL!

GNU ASYM STORY

AWESOME TURNING
ASYM AWESOME
BALANCE THROUGH ASYMMETRY



**3 GNU
GLITE**
CONSTRUCTIONS
FSC CERTIFIED ECO WOODS



GNU CONTOURS
BANANA IS TECHNOLOGY
THE ORIGINAL ROCKER/CAMBER HYBRID CONTOURS.
PATENT #7823892 #8511704

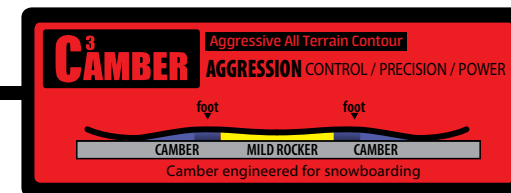
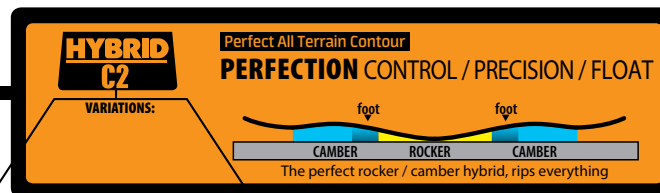
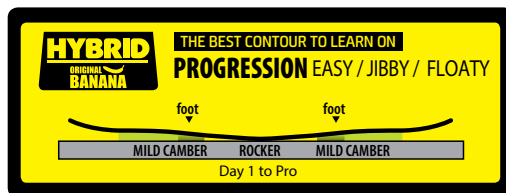
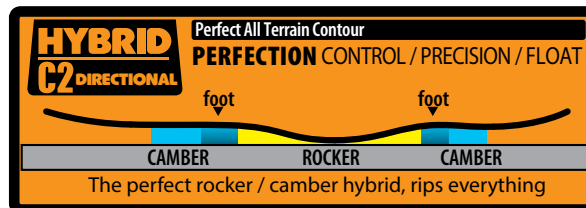

Easy Riding
All Terrain Contour



Xtreme Riding
All Terrain Contour

MERVIN MADE
HANDMADE IN THE USA



25
26

Gnu

SNOWBOARDS



Gnu
156





25
26



Gnu
SNOWBOARDS



©Gnu.

Fiction



25
26

Gnu
SNOWBOARDS





25
26

Gnu
SNOWBOARDS



25
26

Gnu
SNOWBOARDS



TEAM

FOREST BAILEY

JAMIE ANDERSON

MAX WARBINGTON

BARRETT CHRISTY

CANNON CUMMINS

NAIMA ANTOLIN

TEMPLE CUMMINS



MASATO TODA • JADYN CHOMLACK • ELLIE WEILER • MICHAEL MCDANIEL

BRENDAN SULLIVAN • MARKUS RUSTAD • ALEX LOPEZ • ARI MORRONE

JULIAN GLUCK • ISABELLA GOMEZ • CALVIN GREEN • DEREK CONTI



**FOREST
BAILEY**

Gnu
SNOWBOARDS

 **FREESTYLE / PARK** 

MONEYS

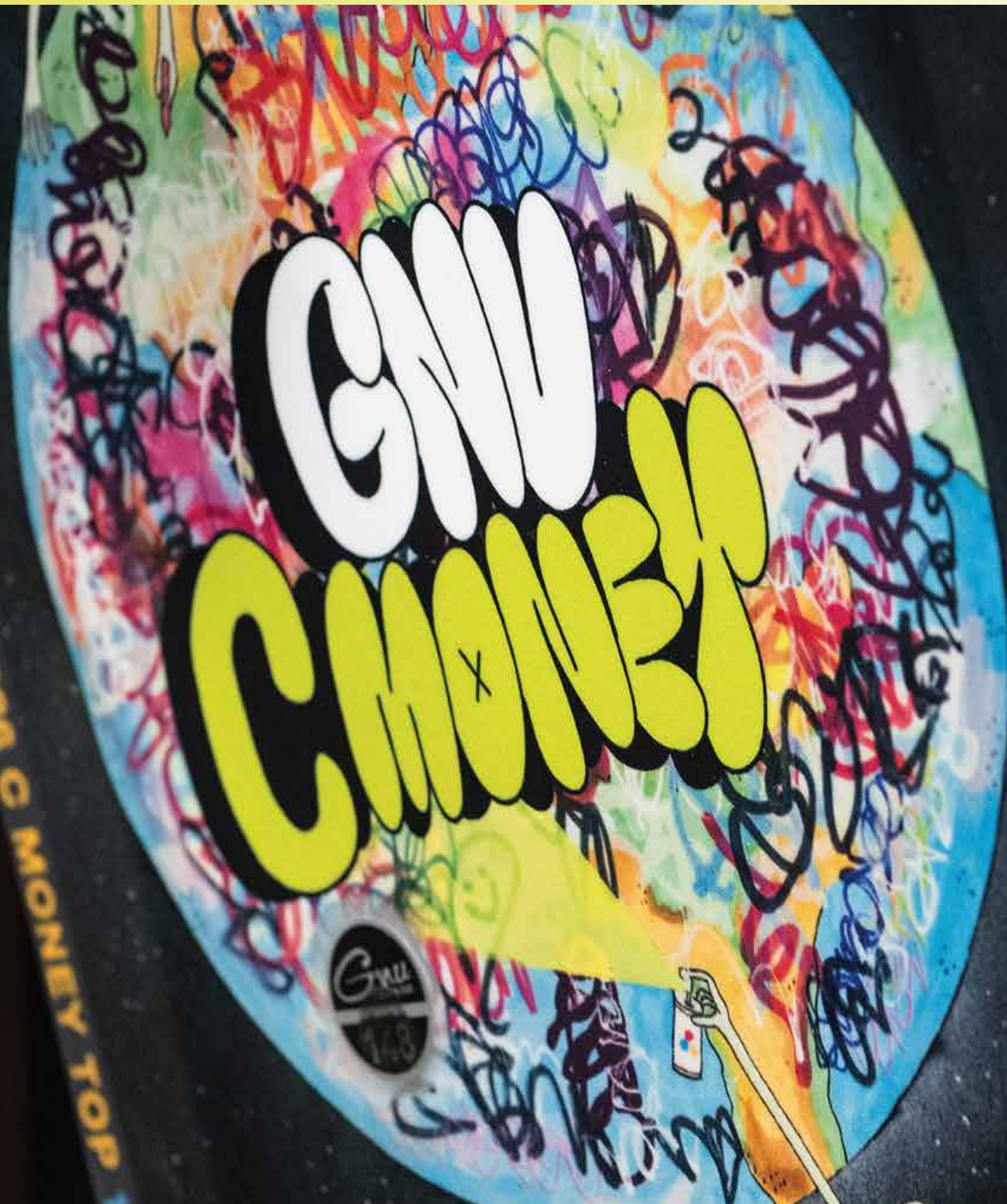

**JAY
HOWELL**



MONEY

FREESTYLE / PARK / TWIN SHAPE

MENS

- Freestyle fun and passionate progression
- Plays in the park rips the resort
- Amazing quality, performance and price

Art: JAY HOWELL
@punksgitcut



A perfect twin park preferring board that shreds the whole mountain. Featuring a snappy C2 rocker camber hybrid contour, sustainable fast growing wood core and eco sublimated graphics. All the shred bling without the crypto sting. The Money and the Young Money are our gifts to snowboarding's past, present and future.

TERRAIN TYPES



RIDER ABILITY



FLEX SCALE



MAGNE-TRACTION®
EDGE HOLD ADVANTAGE

HYBRID
C2®

Easy Riding All Terrain Contour



CORE: G LITE 1 FSC Certified Poplar + Paulownia Core: Light, Strong And Poppy

GLASS: Tri-Ax/Bi-Ax Glass: Strong And Poppy

TOP: Eco Sublimated Poly Top: Tough And Environmentally Nice.

BASE: Eco Sublimated Co-Ex Base: Fast, Tough And Holds Wax

SIDEWALL & TIPS/TAILS: UHMW: Tough And Fast

	LENGTH	CONTACT LENGTH	SIDE CUT	NOSE WIDTH	WAIST WIDTH	TAIL WIDTH	STANCE MIN-MAX/SET BACK
	130	97cm	7.1	26.1	23	26.1	17.5"-20.75"/0"
	135	100cm	7.4	26.8	23.2	26.8	17.5"-20.75"/0"
	140	103cm	7.7	27	23.4	27	17.75-22.5" / 0"
	144	110cm	7.9	27.9	24.2	27.9	19"-24" / 0"
	148	113cm	8	28.6	24.7	28.6	19"-24" / 0"
	152	115cm	8.1	29.3	25.3	29.3	20.25"-25"/0"
	154	116cm	8.1	29.5	25.4	29.5	20.25"-25"/0"
	156	117cm	8.2	29.6	25.5	29.6	20.25"-25"/0"
	159	119cm	8.2	29.8	25.6	29.8	20.25"-25"/0"
WIDE	150 w*	113cm	8	29.9	26	29.9	20.25"-25"/0"
	154 w*	116cm	8.1	30.3	26.2	30.3	20.25"-25"/0"
	158 w*	119cm	8.2	30.9	26.6	30.9	20.25"-25"/0"



WE BUILD OUR OWN DAMN BOARDS



GLOSS

FREESTYLE / PARK / TWIN SHAPE

WOMENS

- True twin park focused style stick
- For easy progression and effortless flare
- Understated glam with underpriced tech

Art: Sara Phillips
@philllips



The Gloss is a twin freestyle board for playful park fun or all mountain freestyle action. It's got a blunted twin shape, a friendly flex, and a C2e camber hybrid contour, the perfect rocker/camber hybrid. The Gloss puts a shine on your moves, with Magne-Traction® for catch-free edge control. understated glam, effortless style, underpriced tech, and unreal snowboarding!

TERRAIN TYPES



RIDER ABILITY



FLEX SCALE



MAGNE-TRACTION®
EDGE HOLD ADVANTAGE

HYBRID C2®

Easy Riding All Terrain Contour



CORE: G LITE 1 FSC Certified Aspen + Paulownia Core: Light, Strong And Poppy

GLASS: Tri-Ax/Bi-Ax Glass: Strong And Poppy

TOP: Eco Sublimated Poly Top: Tough And Environmentally Nice.

BASE: Eco Sublimated Co-Ex Base: Fast, Tough And Holds Wax

SIDEWALL & TIPS/TAILS: UHMW: Tough And Fast

LENGTH	CONTACT LENGTH	SIDE CUT	NOSE WIDTH	WAIST WIDTH	TAIL WIDTH	STANCE MIN-MAX/SET BACK
136	103cm	7.8	26.1	22.6	26.1	17"-22" / 0"
140	105cm	7.9	27.2	23.3	27.2	17"-22" / 0"
144	107cm	8	27.6	23.5	27.6	18.5"-23.5" / 0"
148	110cm	8.1	27.9	23.9	27.9	18.5"-23.5" / 0"



WE BUILD OUR OWN DAMN BOARDS

C MONEY



MENS

FREESTYLE / PARK / TWIN SHAPE

- Cambered freestyle and progression
- Pops in the park rips the resort
- Amazing quality, performance and price

Art: JAY HOWELL
@punksgitcut



A perfect cambered twin park preferring board that shreds the whole mountain. Featuring a poppy C3 cambered contour, sustainable fast growing wood core and eco sublimated graphics. All the shred bling without the crypto sting. The C Money is pop you can buy and guaranteed to take your freestyle game to the next level.

TERRAIN TYPES



RIDER ABILITY



FLEX SCALE



MAGNE-TRACTION®
EDGE HOLD ADVANTAGE

C³ CAMBER

Aggressive All Terrain Contour



CORE: G LITE 1 FSC Certified Poplar + Paulownia Core: Light, Strong And Poppy

GLASS: Tri-Ax/Bi-Ax Glass: Strong And Poppy

TOP: Eco Sublimated Poly Top: Tough And Environmentally Nice.

BASE: Eco Sublimated Co-Ex Base: Fast, Tough And Holds Wax

SIDEWALL & TIPS/TAILS: UHMW: Tough And Fast

LENGTH	CONTACT LENGTH	SIDE CUT	NOSE WIDTH	WAIST WIDTH	TAIL WIDTH	STANCE MIN-MAX/SET BACK
144	110cm	7.9	27.9	24.2	27.9	19"-24" / 0"
148	113cm	8	28.6	24.7	28.6	19"-24" / 0"
152	115cm	8.1	29.3	25.3	29.3	20.25"-25"/0"
154	116cm	8.1	29.5	25.4	29.5	20.25"-25"/0"
156	117cm	8.2	29.6	25.5	29.6	20.25"-25"/0"
159	119cm	8.2	29.8	25.6	29.8	20.25"-25"/0"
150 w*	113cm	8	29.9	26	29.9	20.25"-25"/0"
154 w*	116cm	8.1	30.3	26.2	30.3	20.25"-25"/0"
158 w*	119cm	8.2	30.9	26.6	30.9	20.25"-25"/0"

*WIDE



WE BUILD OUR OWN DAMN BOARDS



GLOSS C

FREESTYLE / PARK / TWIN SHAPE

WOMENS

- Cambered True twin park focused style stick
- Tech progression and effortless flare
- Understated glam with underpriced tech

Art: Sara Phillips
@phillips



The Gloss-C is a cambered twin freestyle board for serious park fun or all mountain freestyle action. It's got a blunted twin shape, a friendly flex, and C3 camber contour specifically designed for snowboarding. The Gloss-C puts a shine on your moves, with Magne-Traction® for catch-free edge control. understated glam, effortless style, underpriced tech, and unreal snowboarding!

TERRAIN TYPES



RIDER ABILITY



FLEX SCALE



MAGNE-TRACTION®
EDGE HOLD ADVANTAGE

C³ CAMBER

Aggressive All Terrain Contour



CORE: G LITE 1 FSC Certified Aspen + Paulownia Core: Light, Strong And Poppy

GLASS: Tri-Ax/Bi-Ax Glass: Strong And Poppy

TOP: Eco Sublimated Poly Top: Tough And Environmentally Nice.

BASE: Eco Sublimated Co-Ex Base: Fast, Tough And Holds Wax

SIDEWALL & TIPS/TAILS: UHMW: Tough And Fast

LENGTH	CONTACT LENGTH	SIDE CUT	NOSE WIDTH	WAIST WIDTH	TAIL WIDTH	STANCE MIN-MAX/SET BACK
136	103cm	7.8	26.1	22.6	26.1	17"-22" / 0"
140	105cm	7.9	27.2	23.3	27.2	17"-22" / 0"
144	107cm	8	27.6	23.5	27.6	18.5"-23.5" / 0"
148	110cm	8.1	27.9	23.9	27.9	18.5"-23.5" / 0"



WE BUILD OUR OWN DAMN BOARDS

HEAD SPACE



**FOREST
BAILEY**

HEAD SPACE



FOREST
BAILEY

HEAD SPACE

FREESTYLE / PARK / TWIN SHAPE By FOREST BAILEY

- Forest's cambered pill creative freestyle vehicle
- Streetwise, rips the resort, toys with the park
- Technology unites your mind, body and board

Board art: Forest Bailey
@forestbailey



MENS

A classic freestyle pill shape from his beautiful mind. The cambered Head Space is Forest's twin freestyle mind expansion tool. A proven street slayer, rips any freestyle situation you might encounter at your home resort or out there with the crew. Magne-Traction® edge control, FSC certified eco core, sintered eco sublimated base. Find your feet with a board that knows anything and everything is possible.

TERRAIN TYPES



RIDER ABILITY



FLEX SCALE



MAGNE-TRACTION®
EDGE HOLD ADVANTAGE

C³ CAMBER

Aggressive All Terrain Contour



CORE: G LITE 2 FSC Certified Aspen + Paulownia Core: Light, Strong And Poppy

GLASS: Tri-Ax/Bi-Ax Glass + Carbon Power Bands: Strong And Poppy

TOP: Eco Sublimated Poly Top: Tough And Environmentally Nice

BASE: Eco Sublimated Sintered Base: Fast, Tough And Holds Wax

SIDEWALL & TIPS/TAILS: UHMW: Tough And Fast

LENGTH	CONTACT LENGTH	SIDE CUT	NOSE WIDTH	WAIST WIDTH	TAIL WIDTH	STANCE MIN-MAX/SET BACK
146	110 cm	7.7	28.3	24.7	28.3	19"-24"/ 0"
149	112 cm	7.8	29.1	25	29.1	20.25"-25"/ 0"
152	113 cm	8	29.4	25	29.4	20.25"-25"/ 0"
155	115 cm	8.2	29.7	25.4	29.7	20.25"-25"/ 0"
158	117 cm	8.3	30	25.5	30	20.25"-25"/ 0"
155W*	115 cm	8.2	30.5	26.4	30.5	20.25"-25"/ 0"

*WIDE



WE BUILD OUR OWN DAMN BOARDS



**RECESS
PACKAGE BOX**



Art: Hannah Eddy
@hannaheddyart

RECESS PACKAGE

NEW!

RECESS PACKAGE 80, 90, 100

YOUTH ALL MOUNTAIN FREESTYLE / TWIN

UNISEX

- Radial Sidecut - Smooth and predictable turns
- Full Wood Core - Light, strong, and poppy
- Cap Construction



SPEED STRAP BINDING

- SIZE: X-SMALL** (US 12C-5)
- Single Buckle Speed-Strap
 - Quick Adjust Heelcup

The Recess package is a great introduction to snowboarding for kids. The bindings are easily adjustable, feature comfy straps and are sized right for the board. A soft flex, catch free radial sidecut, and flat stable contour make the Recess a perfect introduction to all mountain fun!

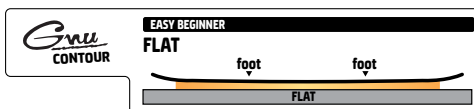

LENGTH (cm)	CONTACT LENGTH (cm)	SIDECUT (m)	WAIST WIDTH (cm)	NOSE / TAIL WIDTH (cm)	STANCE / SETBACK (cm)
80	50	4.0	20.0	22.0 / 22.0	11.0"-13.5" / 0"
90	60	5.5	21.0	22.5 / 22.5	11.0"-14.0" / 0"
100	66	5.7	21.0	23.6 / 23.6	11.0"-14.0" / 0"

RECESS PACKAGE 110, 120, 125

YOUTH ALL MOUNTAIN FREESTYLE / TWIN

- MAGNE-TRACTION® - Effortless Edge Hold
- Full Wood Core - Light, strong, and poppy
- Sandwich Construction



TRADITIONAL BINDING

- SIZE: SMALL** (US 2-7)
- Height Adjustable Highback
 - Padded EVA Highback
 - Adjustable Heelcup

The Recess package is a great introduction to snowboarding for kids. The bindings are easily adjustable, feature comfy straps and are sized right for the board. A soft flex, MAGNE-TRACTION® sidecut with effortless edge hold, and flat to 3D early rise contour make the Recess a perfect introduction to all mountain fun!

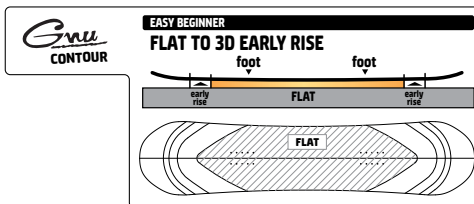

LENGTH (cm)	CONTACT LENGTH (cm)	SIDECUT (m)	WAIST WIDTH (cm)	NOSE / TAIL WIDTH (cm)	STANCE / SETBACK (cm)
110	74	6.5	22	24.3 / 24.3	13"-16" / 0"
120	85	6.7	22.5	25.2 / 25.2	15"-18" / 0"
125	94	7	22.7	25.4 / 25.4	16"-19" / 0"





**NAIMA
ANTOLIN**



 **FREESTYLE /**  **SNOWBOARDS** |
ALL MOUNTAIN 

NEW!



FACTS



MENS

FREESTYLE / ALL MOUNTAIN / DIRECTIONAL TWIN

- The perfect freestyle minded snowboard
- Rips everything you can see from the chair and loves a rope tow
- Amazing American craftsmanship, performance and value

Fun, easy to ride and packed with performance features the FACTS is the culmination of decades of all terrain freestyle resort focused snowboard design. A ready for everything, catch free, carvy, floaty BTX Hybrid contour. Magne-Traction® serrated edges offer effortless edge hold on ice and hardpack. Lively, poppy, long lasting eco-friendly construction with a fast low maintenance base.

TERRAIN TYPES



RIDER ABILITY



FLEX SCALE



MAGNE-TRACTION®
EDGE HOLD ADVANTAGE

HYBRID
ORIGINAL BANANA

THE BEST CONTOUR TO LEARN ON



CORE: G LITE 1 FSC Certified Aspen + Paulownia Core: Light, Strong And Poppy

GLASS: Tri-Ax/Bi-Ax Glass: Strong And Poppy

TOP: Eco Sublimated Poly Top: Tough And Environmentally Nice.

BASE: Eco Knife Cut Co-Ex Base: Fast, Tough And Holds Wax

SIDEWALL & TIPS/TAILS: UHMW: Tough And Fast

LENGTH	CONTACT LENGTH	SIDE CUT	NOSE WIDTH	WAIST WIDTH	TAIL WIDTH	STANCE MIN-MAX/SET BACK
147	109 cm	8	28.1	24.2	28.1	17"-22" / 75"
150	111 cm	8.1	28.2	24.5	28.2	19.24"-24"/ 75"
153	114.5 cm	8.2	28.9	24.8	28.9	20.25"-25"/ 75"
156	119 cm	8.2	29.8	25.4	29.8	20.25"-25"/ 75"
159	121 cm	8.3	30.2	25.5	30.2	20.25"-25"/ 75"
156 w*	119 cm	8.3	31.1	26.7	31.1	20.25"-25"/ 75"
159 w*	121 cm	8.3	31.2	26.7	31.2	20.25"-25"/ 75"
162 w*	122 cm	8.4	31.4	26.7	31.4	20.25"-25"/ 75"

*WIDE





Board Art: Gnu Snowboards
@gnusnowboards



WE BUILD OUR OWN DAMN BOARDS



NEW!  **FICTION** 

WOMENS

FREESTYLE / ALL MOUNTAIN / DIRECTIONAL TWIN

- Unbelievably easy riding snowboard
- Freestyle progression on the whole mountain
- Magne-Traction® for enhanced edge control

The Fiction is a directional twin all mountain board with an approachable shape, softer flex, and our Original Banana Hybrid contour for catch-free progression. Write the story of your shred dreams in a winter wonderland. The Fiction will make exciting easy reading of any terrain and turns everyday into a magical chapter. Magne-Traction® adds predictable edge-control to the long list of this board's niceties. A lot of tech for a price that will have you wondering if the truth is stranger than fiction.

TERRAIN TYPES



RIDER ABILITY



FLEX SCALE



THE BEST CONTOUR TO LEARN ON



CORE: G LITE 1 FSC Certified Aspen + Paulownia Core: Light, Strong And Poppy

GLASS: Tri-Ax/Bi-Ax Glass: Strong And Poppy

TOP: Eco Sublimated Poly Top: Tough And Environmentally Nice.

BASE: Eco Knife Cut Co-Ex Base: Fast, Tough And Holds Wax

SIDEWALL & TIPS/TAILS: UHMW: Tough And Fast

LENGTH	CONTACT LENGTH	SIDE CUT	NOSE WIDTH	WAIST WIDTH	TAIL WIDTH	STANCE MIN-MAX/SET BACK
133	101 cm	7.5	25.8	22.5	25.8	17"-22" / 0"
139	103 cm	7.6	26.1	22.6	26.1	17"-22" / 0"
142	106 cm	7.7	27	23.2	27	17.75"-22.5"/0"
145	108 cm	7.8	27	23.4	27	17.75"-22.5"/0"
148	112 cm	7.9	28	24	28	18.5"-23.5"/0"
151	114 cm	8	28.3	24.3	28.3	18.5"-23.5"/0"
154	116 cm	8.1	28.7	24.6	28.7	18.5"-23.5"/0"



Board Art: Gnu Snowboards
@gnusnowboards



WE BUILD OUR OWN DAMN BOARDS 



FINEST

MAX
WARBINGTON

FINEST

By MAX WARBINGTON

FREESTYLE / ALL MOUNTAIN / ASYM TWIN SHAPE

- MENS**
- Max Warbington's fine tuned "can do" snowboard
 - Freestyles all terrain with the crew
 - Max's art eco-sublimated on top and into a rugged sintered base

Board art: Max Warbington
@69max420



40 years in we present...The Finest Gnu ever made! Max's ASYM C2x freestyle stick has been fine tuned in pursuit of freestyle progression and perfection. Guaranteed to add depth to your park performance and freestyle freedom to your deep snow game. Grab your crew, feed the animals and go boardin! Absolute control in all terrain is built in.

TERRAIN TYPES



RIDER ABILITY



FLEX SCALE



MAGNE-TRACTION®
EDGE HOLD ADVANTAGE

**HYBRID
C2^x**

Xtreme Riding All Terrain Contour

AWESOME TURNING
ASYM AWESOME
BALANCE THROUGH ASYMMETRY

ASYM



CORE: G LITE 2 FSC Certified Aspen + Paulownia Core: Light, Strong And Poppy

GLASS: Tri-Ax/Bi-Ax Glass: Strong And Poppy

TOP: Eco Sublimated Poly Top: Tough And Environmentally Nice.

BASE: Eco Sublimated Sintered Base: Fast, Tough And Holds Wax

SIDEWALL & TIPS/TAIls: UHMW: Tough And Fast

LENGTH	CONTACT LENGTH	SIDE CUT	NOSE WIDTH	WAIST WIDTH	TAIL WIDTH	STANCE MIN-MAX/SET BACK
148	110 cm	8 / 7.9	28.4	24.8	28.4	19.24"-24"/ 0"
151	111 cm	8.1 / 7.8	28.8	25	28.8	20.25"-25"/ 0"
154	113 cm	8.1 / 7.8	29.1	25.1	29.1	20.25"-25"/ 0"
157	116 cm	8.2 / 7.9	29.7	25.5	29.7	20.25"-25"/ 0"
159	118 cm	8.3 / 8.0	29.9	25.7	29.9	20.25"-25"/ 0"
155 w*	114 cm	8.1 / 7.8	30.4	26.2	30.4	20.25"-25"/ 0"

*WIDE





VELVET

ALL MOUNTAIN / FREESTYLE / TWIN SHAPE

WOMENS

- Twin shape for freestyle progression
- The entire mountain is your creative playground
- Environmentally comfy FSC Certified wood core and a sintered base

Art: Hannah Eddy
@hannaheddyart



The Velvet is the choice of Gnu team riders who approach the whole mountain like their park. It's snappy flex and hybrid C2 contour work in synergy for pop and stability. It features intuitive geometry, and Magne-Traction®, so it is catch-free and responsive. The eco sublimated plant-based graphics give this ride a down to earth vibe. The Velvet is comfortable in any conditions and as balanced in the park as it is in banked slaloms or street sessions. Design conceptualized by Naima Antolin and art by Hannah Eddy.

TERRAIN TYPES



RIDER ABILITY



FLEX SCALE



MAGNE-TRACTION®
EDGE HOLD ADVANTAGE

**HYBRID
C2**

Perfect All Terrain Contour



CORE: G LITE 2 FSC Certified Aspen + Paulownia Core: Light, Strong And Poppy

GLASS: Tri-Ax/Bi-Ax Glass: Strong And Poppy

TOP: Eco Sublimated Poly Top: Tough And Environmentally Nice.

BASE: Eco Sublimated Sintered Base: Fast, Tough And Holds Wax

SIDEWALL & TIPS/TAILS: UHMW: Tough And Fast

LENGTH	CONTACT LENGTH	SIDE CUT	NOSE WIDTH	WAIST WIDTH	TAIL WIDTH	STANCE MIN-MAX/SET BACK
139	103 cm	7.6	26.1	22.6	26.1	17"-22" / 0"
143	105 cm	7.7	27.2	23.5	27.2	18.5"-23.5" / 0"
147	107 cm	7.8	28	23.9	28	18.5"-23.5" / 0"
150	110 cm	7.9	28.3	23.9	28.3	19.24"-24" / 0"
153	113 cm	8	28.7	24.1	28.7	19.24"-24" / 0"



RIDERS CHOICE



FREESTYLE / ALL MOUNTAIN / ASYM TWIN SHAPE

- MENS**
- A board for riders by riders
 - Poppy powerful 3-D Asym Chip power platforms
 - Intuitive Asym advantage maximizes performance

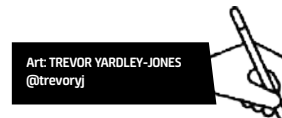

Undeniable 3-D Delightwood Asym Chip construction on proven Asym geometries distribute energy to your edges and elevate pop, power and performance. The Gnu squad had a strong hand in this one combining; asymmetry, slightly wider widths that rail and float with C2 Hybrid contours that pop, slide, carve and lift. All laminated into an eco-minded construction with poppy carbon that is built to blast and last. It's quite possibly the best snowboard we have ever made!

TERRAIN TYPES



RIDER ABILITY



FLEX SCALE



Xtreme Riding All Terrain Contour



CORE: G LITE 3 FSC Certified Aspen + Paulownia Core Lightest, Stronger And Most Poppy

GLASS: Tri-Ax/Bi-Ax Glass + Carbon Power Bands: Strong And Poppy

TOP: Eco Sublimated Poly Top: Tough And Environmentally Nice

BASE: Sintered Knife-Cut Base: Fast, Tough And Holds Wax

SIDEWALL & TIPS/TAILS: UHMW: Tough And Fast

LENGTH	CONTACT LENGTH	SIDE CUT	NOSE WIDTH	WAIST WIDTH	TAIL WIDTH	STANCE MIN-MAX/SET BACK
151.5	113 cm	7.9 / 8.2	29.2	25.1	29.2	20-24.75" 0"
154.5	116 cm	7.7 / 8.1	29.3	25.2	29.3	20.25"-25" 0"
157.5	119 cm	7.8 / 8.2	29.9	25.5	29.9	20.25"-25" 0"
159.5	120 cm	7.9 / 8	30	25.6	30	20.25"-25" 0"
161.5	122 cm	8 / 8.4	30.2	25.8	30.2	20.25"-25" 0"
155 W*	116 cm	7.7 / 8.1	30.7	26.5	30.7	20.25"-25" 0"
158 W*	119 cm	7.8 / 8.2	31.2	26.8	31.2	20.25"-25" 0"
162 W*	122 cm	8 / 8.4	31.3	26.8	31.3	20.25"-25" 0"

*WIDE



WE BUILD OUR OWN DAMN BOARDS



LADIES CHOICE



Wahwah

**JAMIE
ANDERSON**



LADIES CHOICE

By **JAMIE ANDERSON**



WOMENS

FREESTYLE / ALL MOUNTAIN / ASYM TWIN SHAPE

- Jamie Anderson's asym twin fun freestyle choice
- Carves, flies and floats the whole mountain
- Knife cut sintered base and carbon power bands

Board art: Sarah King
@sarahkingart



The Ladies Choice has secured its place in snowboarding history with over a decade of collaboration with the most decorated female snowboarder, Jamie Anderson. Her balance between progression and playfulness is reflected in the progressive asym technology and a C2x camber hybrid contour, perfectly tuned for freestyle flow. Bringing Jamie's eco-minded sensibility to our construction materials and process, the Ladies Choice is built with a sustainably harvested FSC certified wood core and water-based inks. Eco sublimated graphics by Sarah King continue the decade + partnership with this all-mountain freestyle work of art. Ride the Ladies Choice and channel some JA magic! Board

TERRAIN TYPES



RIDER ABILITY



FLEX SCALE



MAGNE-TRACTION®
EDGE HOLD ADVANTAGE

HYBRID C2

Xtreme Riding All Terrain Contour

AWESOME TURNING
ASYM AWESOME
BALANCE THROUGH ASYMMETRY

ASYM



CORE: G LITE 3 FSC Certified Aspen + Paulownia Core Lightest, Stronger And Most Poppy

GLASS: Tri-Ax/Bi-Ax Glass + Carbon Power Bands: Strong And Poppy

TOP: Eco Sublimated Bio Beans: Tough And Environmentally Nice

BASE: Sintered Knife-Cut Base: Fast, Tough And Holds Wax

SIDEWALL & TIPS/TAIls: UHMW: Tough And Fast

LENGTH	CONTACT LENGTH	SIDE CUT	NOSE WIDTH	WAIST WIDTH	TAIL WIDTH	STANCE MIN-MAX/SET BACK
139.5	103 cm	7.8 / 7.6	26.1	22.6	26.1	17"-22"/ 0"
142.5	107 cm	8.0 / 7.7	27	23.2	27	18.5"-23.5"/0"
145.5	109 cm	8.1 / 7.8	27.9	24	27.9	18.5"-23.5"/0"
148.5	111 cm	8.2 / 7.9	28	24.2	28	18.5"-23.5"/0"
151.5	114 cm	8.3 / 8.0	28.5	24.4	28.5	19.24"-24"/ 0"
153.5	116 cm	8.3 / 8.0	28.6	24.4	28.6	19.24"-24"/ 0"



WE BUILD OUR OWN DAMN BOARDS

NEW!



WAGYU



NEW!



**CANNON
CUMMINS**

25

**EARLY
RELEASE**

26



NEW!

WAGYU

NEW!



**CANNON
CUMMINS**

**JADYN
CHOMLACK**

25 EARLY RELEASE 26

NEW! WAGYU

By CANNON CUMMINS

FREESTYLE / ALL MOUNTAIN DIRECTIONAL TWIN

- MENS**
- Cannon Cummins and crew's delicious beefy Freestyle Stick
 - Resort and park performance
 - Easy riding, transition finding freestyle progression power stomper

Art: Jayden Chomlack
@jadynchomlack



Cannon and the homies' go-to resort and park ripping board. A directional twin shape that eats marbled mountains, devours side hits and gobbles in the park. Featuring some smooth camber with a banger flex that will stomp to your needs. Cannon and crew manned the grill and cooked this one to perfection for park vibes and top to bottom resort freestyle slayers. Wagyu G2 core and sublimated Co-Ex base, with design help by Jadyn goes the full 8 seconds.

TERRAIN TYPES



RIDER ABILITY



FLEX SCALE



MAGNE-TRACTION®
EDGE HOLD ADVANTAGE

3rd CAMBER
Aggressive All Terrain Contour



CORE: G LITE 2 FSC Certified Aspen + Paulownia Core: Light, Strong And Poppy

GLASS: Tri-Ax/Bi-Ax Glass + Carbon Power Bands: Strong And Poppy

TOP: Eco Sublimated Poly Top: Tough And Environmentally Nice

BASE: Eco Sublimated Co-Ex Base: Fast, Tough And Holds Wax

SIDEWALL & TIPS/TAILS: UHMW: Tough And Fast

LENGTH	CONTACT LENGTH	SIDE CUT	NOSE WIDTH	WAIST WIDTH	TAIL WIDTH	STANCE MIN-MAX/SET BACK
155	115 cm	8	29.3	25.3	29.3	18.5"-26.5"/.5"
158	117.5 cm	8	29.5	25.5	29.5	18.5"-26.5"/.5"
161	120 cm	8.1	29.7	25.7	29.7	18.5"-26.5"/.5"



WE BUILD OUR OWN DAMN BOARDS



LADIES CHOICE

NEW!
GAMBER
NEW!



JAMIE
ANDERSON



WOMENS

LADIES CHOICE CAMBER

By **JAMIE ANDERSON**

FREESTYLE / ALL MOUNTAIN / ASYM TWIN SHAPE

- Jamie Anderson's asym twin fun freestyle choice
- Carves, flies and floats the whole mountain
- Knife cut sintered base and carbon power bands

Board art: Sarah King
@sarahkingart



Jamie Anderson continues to set the bar high for herself, and in the process, she has redefined what is possible for the world's best female snowboarders. She is a pro, in every sense of the word, and the Ladies Choice Camber is her choice for big days chasing big dreams. The C3 camber dominant contour, asymmetry and Magne-Traction® ensure pop and stability. Our most premium materials, construction and eco-sublimated art by Sarah King add up to a board that is as pro-earth as it is pro-performance.

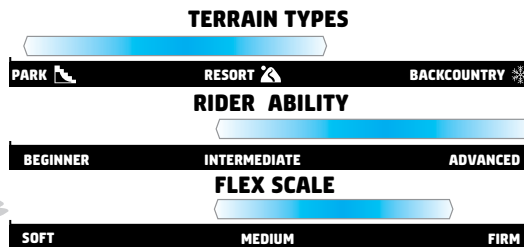

MAGNE-TRACTION®
EDGE HOLD ADVANTAGE

C³ CAMBER

Aggressive All Terrain Contour

AWESOME TURNING
ASYM AWESOME
BALANCE THROUGH ASYMMETRY



CORE: G LITE 3 FSC Certified Aspen + Paulownia Core Lightest, Stronger And Most Poppy

GLASS: Tri-Ax/Bi-Ax Glass + Carbon Power Bands: Strong And Poppy

TOP: Eco Sublimated Bio Beans: Tough And Environmentally Nice

BASE: Sintered Knife-Cut Base: Fast, Tough And Holds Wax

SIDEWALL & TIPS/TAILS: UHMW: Tough And Fast



LENGTH	CONTACT LENGTH	SIDE CUT	NOSE WIDTH	WAIST WIDTH	TAIL WIDTH	STANCE MIN-MAX/SET BACK
145.5	109 cm	8.1 / 7.8	27.9	24	27.9	18.5"-23.5"/0"
148.5	111 cm	8.2 / 7.9	28	24.2	28	18.5"-23.5"/0"
151.5	114 cm	8.3 / 8.0	28.5	24.4	28.5	19.24"-24"/0"



WE BUILD OUR OWN DAMN BOARDS



Cannon Cummins

CANNON
CUMMINS

| *Gnu* |
SNOWBOARDS

gnu ALL MOUNTAIN *gnu*

ANTIGRAVITY

FREESTYLE / ALL MOUNTAIN DIRECTIONAL TWIN

- MENS**
- Directional camber freeride perfection
 - Rips the resort top to bottom
 - Radical quality, performance and price

Board art: Shawn Bishop
@stishbish



Gnu has been rooted in weightless fun since forever. The directional C3 Antigravity honors our ethos by ignoring the past and being perfectly designed for modern snowboarding good times. An easy riding one board quiver with a feel good sustainable wood core, Magne-Traction® serrated edges, an eco-sublimated low maintenance base and proven all terrain geometries. Radical!

TERRAIN TYPES



RIDER ABILITY



FLEX SCALE



TEXTURED TOP SHEET

MAGNE-TRACTION®
EDGE HOLD ADVANTAGE

C³ CAMBER

Aggressive All Terrain Contour



CORE: G LITE 1 FSC Certified Aspen + Paulownia Core: Light, Strong And Poppy

GLASS: Tri-Ax/Bi-Ax Glass: Strong And Poppy

TOP: Eco Sublimated Poly Top: Tough And Environmentally Nice.

BASE: Eco Sublimated Co-Ex Base: Fast, Tough And Holds Wax

SIDEWALL & TIPS/TAILS: UHMW: Tough And Fast

LENGTH	CONTACT LENGTH	SIDE CUT	NOSE WIDTH	WAIST WIDTH	TAIL WIDTH	STANCE MIN-MAX/SET BACK
150	106cm	8	28.8	25	28.5	18.5"-23.25"/1"
153	108cm	8	29.2	25.2	29	19.25"-24"/1"
156	111cm	8	29.7	25.5	29.4	20.5"-25"/1"
159	113cm	8.1	30.1	25.7	29.7	20.5"-25"/1"
162	116cm	8.1	30.3	25.8	30	20.5"-25"/1"
159 w*	113cm	8.1	31.1	26.7	30.7	20.5"-25"/1"
162 w*	116cm	8.1	31.3	26.8	31	20.5"-25"/1"

*WIDE



WE BUILD OUR OWN DAMN BOARDS

FROSTING



WOMENS

ALL MOUNTAIN / DIRECTIONAL SHAPE

- Directional shape C2 camber hybrid, perfect all terrain contour
- Friendly flex for float and flow
- Sintered base and eco-friendly construction

Art: Naima Antolin
@naimaantolin



The Frosting is a sweet directional C2 camber hybrid board, built for all mountain adventures. It packs enough power to boost confidence in any terrain, magne-traction® for stable edge-control, and a friendly flex that floats in the pow and maneuvers with ease. Eco sublimated art with water based inks and a sintered base are ingredients for a frosting that is far superior to the other sugary confections on the market.

TERRAIN TYPES

PARK RESORT BACKCOUNTRY

RIDER ABILITY

BEGINNER INTERMEDIATE ADVANCED

FLEX SCALE

SOFT MEDIUM FIRM

MAGNE-TRACTION®
EDGE HOLD ADVANTAGE

**HYBRID
C2**

Perfect All Terrain Contour



CORE: G LITE 2 FSC Certified Aspen + Paulownia Core: Light, Strong And Poppy

GLASS: Tri-Ax/Bi-Ax Glass: Strong And Poppy

TOP: Eco Sublimated Poly Top: Tough And Environmentally Nice.

BASE: Eco Sublimated Sintered Base: Fast, Tough And Holds Wax

SIDEWALL & TIPS/TAILS: UHMW: Tough And Fast

LENGTH	CONTACT LENGTH	SIDE CUT	NOSE WIDTH	WAIST WIDTH	TAIL WIDTH	STANCE MIN-MAX/SET BACK
143	108 cm	7.7	27.7	24	27.5	17"-22" / 1"
146	110 cm	7.8	27.9	24.1	27.7	18"-23" / 1"
149	112 cm	7.9	28.1	24.3	27.9	18"-23" / 1"
152	114 cm	8	28.5	24.4	28.3	18.5"-23.5" / 1"



GREMLIN



BM*GW

GREMLIN



ALL MOUNTAIN / DIRECTIONAL SHAPE

UNISEX

- Take over any mountain
- Loves pow, eats hardpack and ice
- Camber, Magne-Traction®, sintered, self centered
- Mild volume Shift. Ride this board 2 cm shorter than your normal board

Art: Gnu Gift Shop
@gnusnowboards



The Gremlin. A one board quiver for advanced snowboarders looking to get more attention from the chair and in the bar. Floaty nose sniffs out powder, camber body pops over skiers and ropelines. Sintered base scratches rocks and crushes people who didn't know you were racing them to the bottom. The only snowboard on the planet that tells the truth...lies are to hard to remember when fire burns. A great idea that should have always been...Grab a Gremlin!

TERRAIN TYPES



RIDER ABILITY



FLEX SCALE



Aggressive All Terrain Contour



CORE: G LITE 2 FSC Certified Aspen + Paulownia Core: Light, Strong And Poppy

GLASS: Tri-Ax/Bi-Ax Glass: Strong And Poppy

TOP: Eco Sublimated Poly Top: Tough And Environmentally Nice.

BASE: Sintered Knife-Cut Base: Fast, Tough And Holds Wax

SIDEWALL & TIPS/TAIls: UHMW: Tough And Fast

LENGTH	CONTACT LENGTH	SIDE CUT	NOSE WIDTH	WAIST WIDTH	TAIL WIDTH	STANCE MIN-MAX/SET BACK
144	102 cm	6.6	30	25.5	28.8	18.5"-23.25"/ 2"
148	104 cm	6.8	30.3	25.8	29.1	18.5"-23.25"/ 2"
152	106 cm	7	30.9	26.1	29.7	19.25"-24"/ 2"
155	108 cm	7.2	31.3	26.4	30.1	19.25"-24"/ 2"
158	110 cm	7.5	32.1	27	30.8	19.25"-24"/ 2"
161	112 cm	7.7	32.6	27.5	31.3	19.25"-24"/ 2"



BARRETT



**BARRETT
CHRISTY**



BARRETT

By BARRETT CHRISTY



WOMENS

ALL MOUNTAIN / DIRECTIONAL SHAPE

- Barrett's pro model evolution for the directional revolution
- All Terrain camber dominant power player
- Progressive Magne-Traction® and Carbon Power Bands: Radical response and pop

Art: Ryder Biolos
@artbyryder



The award-winning Barrett is the pinnacle of all mountain design. 25+ years of women's board design heritage has culminated in the Barrett. Camber perfection for stability and control, Carbon strips for light-weight snap and edge-to-edge torsional precision. Progressive Magne-traction® because edge control is the foundation for everything awesome in snowboarding. The evolution of Barrett's model is premium performance perfection in a pretty package. A portion of proceeds from the sale of this board is donated to Boarding for Breast Cancer @b4bc to support youth focused education, health and wellness programs.

TERRAIN TYPES



RIDER ABILITY



FLEX SCALE



Aggressive All Terrain Contour



CORE: G LITE 3 FSC Certified Aspen + Paulownia Core Lightest, Stronger And Most Poppy

GLASS: Tri-Ax/Bi-Ax Glass + Carbon Power Bands: Strong And Poppy

TOP: Eco Sublimated Poly Top: Tough And Environmentally Nice

BASE: Sintered Knife-Cut Base: Fast, Tough And Holds Wax

SIDEWALL & TIPS/TAIJS: UHMW: Tough And Fast



Portion of sales benefits

LENGTH	CONTACT LENGTH	SIDE CUT	NOSE WIDTH	WAIST WIDTH	TAIL WIDTH	STANCE MIN-MAX/SET BACK
146	110 cm	8	27.8	24.1	27.5	17"-22"/1.5"
149	113 cm	8.1	28.1	24.3	27.8	18"-23"/1.5"
152	116 cm	8.1	28.6	24.5	28.2	18"-23"/1.5"
155	118 cm	8.1	29.1	24.8	28.8	18"-23"/1.5"



NEW!
UPGRADE
NEW!

UPGRADE
GNU
UPGRADE

**HENDO
DESIGN**

NEW!



UPGRADE



A DOUBLE DOSE OF UPGRADED TECH

HENDO DESIGN Harmonic Performance Package

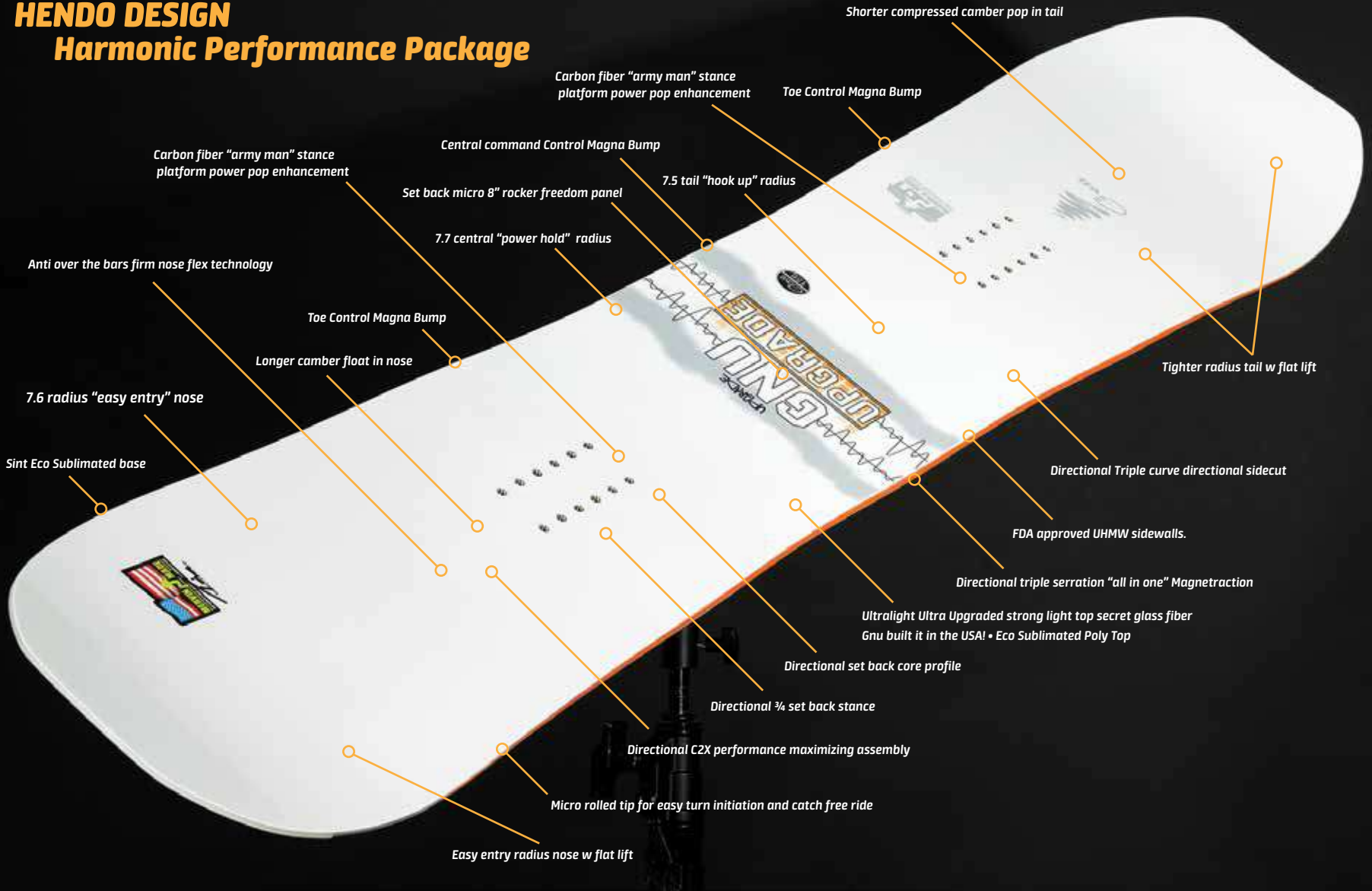

Shorter compressed camber pop in tail

Carbon fiber "army man" stance platform power pop enhancement

Toe Control Magna Bump

Carbon fiber "army man" stance platform power pop enhancement

Central command Control Magna Bump

7.5 tail "hook up" radius

Set back micro 8" rocker freedom panel

7.7 central "power hold" radius

Anti over the bars firm nose flex technology

Toe Control Magna Bump

Longer camber float in nose

Tighter radius tail w flat lift

7.6 radius "easy entry" nose

Directional Triple curve directional sidecut

Sint Eco Sublimated base

FDA approved UHMW sidewalls.

Directional triple serration "all in one" Magntraction

Ultralight Ultra Upgraded strong light top secret glass fiber
Gnu built it in the USA! • Eco Sublimated Poly Top

Directional set back core profile

Directional 3/4 set back stance

Directional C2X performance maximizing assembly

Micro rolled tip for easy turn initiation and catch free ride

Easy entry radius nose w flat lift

NEW! **UPGRADE**

FREESTYLE/ALL MOUNTAIN DIRECTIONAL TWIN HYBRID

MENS

- Mervin action hero craftsmen Hendo's 30 year anniversary project
- Freestyle minded ATV resort slayer
- Precise harmonized pressure and technology mapping puts contours and stacks of features where they need to be

Creative vision Jeff Henderson
@jeffhendo



Lifetime shredder and 30 year Mervin craftsmen Jeff "Hendo" Henderson's high tech resort freestyle stick. 5 years of prototyping and refinement went into blending, optimizing and harmonizing almost every geometry variable possible into this high tech directional twin ATV. "One board to rule them all" - Hendo.

A powerful directional C2X contour featuring a short rocker between feet, tighter poppy camber under the back foot and a longer floatier camber extending forward to the nose and combines with a mild early rise...the ride is remarkably close to camber but better...the perfect balance between playful and stable" -Hendo. Directional triple serration magnatraction...focuses control at toes and between feet and leaves tip and tail simple clean and catchfree. Directional triple curve "on demand" sidecut blend features a medium entry, mild middle and deeper aggressive tail sidecut. Directional core profile with stiffened nose for soft snow power, stability and control and a softer tail for control, carving and float. 3/4" stance set back for hardpack freestyle balance and float in soft snow. Micro rolled nose at contact for catch free freestyle. Directional Easy entry radial to "floaty" flat tip and tighter radius directional tail curve. All that and he snuck in a carbon pop enhancement fiber package. Upgrade your shred game with the benefits of technology...more is more...you don't have to think with this poppy easy rider Hendo's brain did the work so you don't have to!

TERRAIN TYPES



RIDER ABILITY



FLEX SCALE



Xtreme Riding All Terrain Contour



UPGRADED CARBON BASE

CORE: G LITE 2 FSC Certified Aspen + Paulownia Core: Light, Strong And Poppy
GLASS: Tri-Ax/Bi-Ax Glass + Carbon Power Bands: Strong And Poppy
TOP: Eco Sublimated Poly Top: Tough And Environmentally Nice
BASE: Eco Sublimated Sintered Base: Fast, Tough And Holds Wax
SIDEWALL & TIPS/TAILS: UHMW: Tough And Fast

LENGTH	CONTACT LENGTH	SIDE CUT	NOSE WIDTH	WAIST WIDTH	TAIL WIDTH	STANCE MIN-MAX/SET BACK
151	110 cm	7.4/7.5/7.3	29.4	25.1	29.4	18.5"-26.5"/.75"
153	112 cm	7.4/7.5/7.3	29.6	25.3	29.6	18.5"-26.5"/.75"
156	114 cm	7.7/7.7/7.5	29.8	25.5	29.8	18.5"-26.5"/.75"
159	116 cm	7.8/7.9/7.7	30	25.7	30	18.5"-26.5"/.75"
157W*	114 cm	7.7/7.7/7.5	30.3	26	30.3	18.5"-26.5"/.75"
160W*	116 cm	7.8/7.9/7.7	30.8	26.5	30.8	18.5"-26.5"/.75"

WIDE*



WE BUILD OUR OWN DAMN BOARDS

FREE SPIRIT



JAMIE
ANDERSON



FREE SPIRIT

By JAMIE ANDERSON

ALL MOUNTAIN / DIRECTIONAL SHAPE

WOMENS

- Directional C3 floaty powerhouse
- Slightly volume shifted design with a freestyle spirit
- Carbon Power Bands: Radical response and pop

Board Art: Sarah King
@sarahkingart



Jamie Anderson's Free Spirit continues to evolve. The Free Spirit model can chase big dreams on big mountains or whimsical wishes on mellow pow days. When she rides this board Jamie lives life to the fullest, with no limitations, no judges, and no boundaries. It's a floaty pow board with a freestyle spirit, capable of stomping big landings and navigating variable terrain with effortless ease. Whether shredding the resort, backcountry, Natural Selection courses, or AK lines the C3 camber dominant contour, Magne-Traction®, tail taper and snappy flex make this board a perfect choice for any spirit quest.

TERRAIN TYPES



RIDER ABILITY



FLEX SCALE



Aggressive All Terrain Contour



CORE: G LITE 3 FSC Certified Aspen + Paulownia Core Lightest, Stronger And Most Poppy

GLASS: Tri-Ax/Bi-Ax Glass + Carbon Power Bands: Strong And Poppy

TOP: Eco Sublimated Bio Beans: Tough And Environmentally Nice

BASE: Sintered Knife-Cut Base: Fast, Tough And Holds Wax

SIDEWALL & TIPS/TAILS: UHMW: Tough And Fast

LENGTH	CONTACT LENGTH	SIDE CUT	NOSE WIDTH	WAIST WIDTH	TAIL WIDTH	STANCE MIN-MAX/SET BACK
148	97 cm	6	31	25.5	29.3	19.24"-24"/ 3"
153	102 cm	6	31.2	25.5	29.5	19.24"-24"/ 3"



**NEW
SHAPE!**

4X4



**FOREST
BAILEY**



**NEW
SHAPE!**



4X4



By **Forest Bailey**

ALL MOUNTAIN / DIRECTIONAL SHAPE

- MENS**
- Forest Bailey's directional ATV
 - Freestyle the entire mountain
 - A street master's big mountain stick

Board art: Forest Bailey
@forestbailey



Forest Bailey is a complete rider...his skateboard roots put him in the streets, his mastery of east coast ice makes him an amazing carver and his love of all things wild put him in the big mountains. A decade of board design experience and experiments went into this magical floaty nosed, zero taper angle, freestyle focused directional ATV. Head Space the streets and 4x4 the wilds. Forest Bailey's two board quiver is built to stack clips for the complete all terrain master part.

TERRAIN TYPES



RIDER ABILITY



FLEX SCALE



MAGNE-TRACTION®
EDGE HOLD ADVANTAGE

3rd CAMBER
Aggressive All Terrain Contour



CORE: G LITE 2 FSC Certified Aspen + Paulownia Core: Light, Strong And Poppy

GLASS: Tri-Ax/Bi-Ax Glass: Strong And Poppy

TOP: Eco Sublimated Poly Top: Tough And Environmentally Nice.

BASE: Eco Sublimated Sintered Base: Fast, Tough And Holds Wax

SIDEWALL & TIPS/TAILS: UHMW: Tough And Fast

LENGTH	CONTACT LENGTH	SIDE CUT	NOSE WIDTH	WAIST WIDTH	TAIL WIDTH	STANCE MIN-MAX/SET BACK
157	119 cm	8.4	29.7	25.5	29.7	19.24"-24"/1"
160	121 cm	8.4	30	25.7	30	19.24"-24"/1"



SOMETHING GNU



Gnu

Graphite Composite Slope Tools

25

**EARLY
RELEASE**

26



**MIKE
OLSON**

*Functional Shape
Functional Carve*



(206) 762-3011

**DRIFTY SNOWBOARDS
AREN'T DELICIOUS**

309 South Cloverdale Suite C-2
Seattle, Wa. 98108

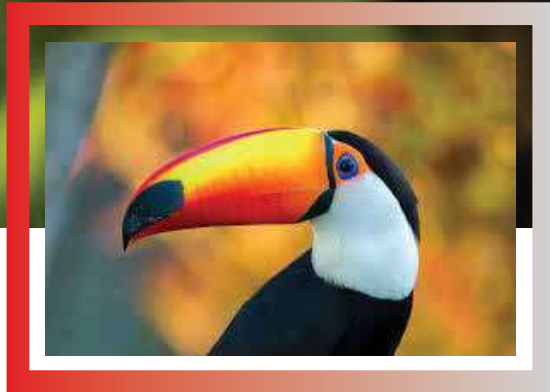

TOUCAN NOSE TECH

EXCLUSIVE TO SOMETHING GNU!

25 EARLY RELEASE 26

SOMETHING GNU

ALL MOUNTAIN FREERIDE / DIRECTIONAL SHAPE

- MENS**
- Gnu's innovative carving / floating historical future flash
 - Deep carving progressive sidecut (Drifty snowboards aren't delicious)
 - Floaty easy entry resort carving pow slayer

Creative Vision: Pete Saari
@turtletater



A great leap forward for mankind...Gnu was credited by TWS mag as being the first brand to market deep carving sidecuts intended for resort hardpack terrain which was a critical step as snowboards evolved from finned backcountry powder designs only to modern all terrain "directional device" resort atvs. Something Gnu takes the inspiration of Mike Olsons early 80s' finless designs and adds in all we have learned over the past 40 years of Gnu board building. Fine tuned progressive sidecuts provide forgiving turn entry and finlike hold in the tail allowing deep powerful trenched carving on hardpack and ice. A long smooth tip entry floats the pow effortlessly on those special days and the swallow tail and taper settles nicely adding even more control and float. A modern directional C2 contour works in harmony with tip and entry sidecut for easy turn entry and the tight shorter camber adds hold in the tail for radical resort power carving. "Drifty Snowboards aren't delicious...business casual in the front power party in the back!

TERRAIN TYPES

PARK RESORT BACKCOUNTRY

RIDER ABILITY

BEGINNER INTERMEDIATE ADVANCED

FLEX SCALE

SOFT MEDIUM FIRM

MAGNE-TRACTION®
EDGE HOLD ADVANTAGE

HYBRID
C2 DIRECTIONAL

Perfect All Terrain Contour



CORE: G LITE 3 FSC Certified Aspen + Paulownia Core Lightest, Stronger And Most Poppy

GLASS: Tri-Ax/Bi-Ax Glass: Strong And Poppy

TOP: Eco Sublimated Poly Top: Tough And Environmentally Nice.

BASE: Sintered Knife-Cut Base: Fast, Tough And Holds Wax

SIDEWALL & TIPS/TAILS: UHMW: Tough And Fast

	LENGTH	CONTACT LENGTH	SIDE CUT	NOSE WIDTH	WAIST WIDTH	TAIL WIDTH	STANCE MIN-MAX/SET BACK
NEW-->	151	104 cm	6.66/6	30	25	29	17.75"-22.5"/4"
	156	108 cm	6.66/6	31	25.3	29.8	17.75"-22.5"/4"
	161	112 cm	6.66/6	31.8	26.1	30.5	19.25"-24"/4"
NEW-->	169	116 cm	6.66/6	32.9	26.5	31.4	19.25"-24"/4"



WE BUILD OUR OWN DAMN BOARDS



**BANKED
COUNTRY**

**TEMPLE
CUMMINS**

BANKED COUNTRY

By TEMPLE & CANNON CUMMINS

ALL MOUNTAIN / DIRECTIONAL SHAPE

- MENS**
- Temple and Cannon's father/son ultra refined design
 - Carbon Power Bands: Radical response and pop
 - New, fast, positive Directional Progressive Magne-Traction® technology

Art: Temple Cummins
@templecummins



The ultimate resort shred stick for advanced rippers who constantly watch the weather and score ridiculous amounts of pow but, rip everyday regardless of the conditions. Designed by legendary freestyle minded resort Billy Goater Temple Cummins and his skateboard influenced son Cannon this fantasy father son project is a refined high performance ATV with one eye on float, the other eye on fly and the third eye on more Baker Banked Slalom gold duct tape. A big floaty nose, a powerful responsive construction, directional camber set back 1.5", mild taper angle, a nice new switch friendly tail and exclusive directional progressive Magne-Traction®. Banked Country is what you want to ride and where you want to be.

TERRAIN TYPES



RIDER ABILITY



FLEX SCALE



PROMAG

C³ CAMBER

Aggressive All Terrain Contour



CORE: G LITE 3 FSC Certified Aspen + Paulownia Core Lightest, Stronger And Most Poppy

GLASS: Tri-Ax/Bi-Ax Glass + Carbon Power Bands: Strong And Poppy

TOP: Eco Sublimated Poly Top: Tough And Environmentally Nice

BASE: Sintered Knife-Cut Base: Fast, Tough And Holds Wax

SIDEWALL & TIPS/TAILS: UHMW: Tough And Fast

LENGTH	CONTACT LENGTH	SIDE CUT	NOSE WIDTH	WAIST WIDTH	TAIL WIDTH	STANCE MIN-MAX/SET BACK
155	112 cm	8.2	29.4	25.3	29.2	19"-24"/ 1.5"
159	114 cm	8.3	29.6	25.4	29.4	20"-25"/ 1.5"
162	116 cm	8.4	29.8	25.5	29.6	20"-25"/ 1.5"
160 W*	114 cm	8.3	30.8	26.5	30.6	20"-25"/ 1.5"
163 W*	116 cm	8.3	31.2	26.5	31	20"-25"/ 1.5"

*WIDE



WE BUILD OUR OWN DAMN BOARDS

BANKED COUNTRY SPLITS

By TEMPLE & CANNON CUMMINS

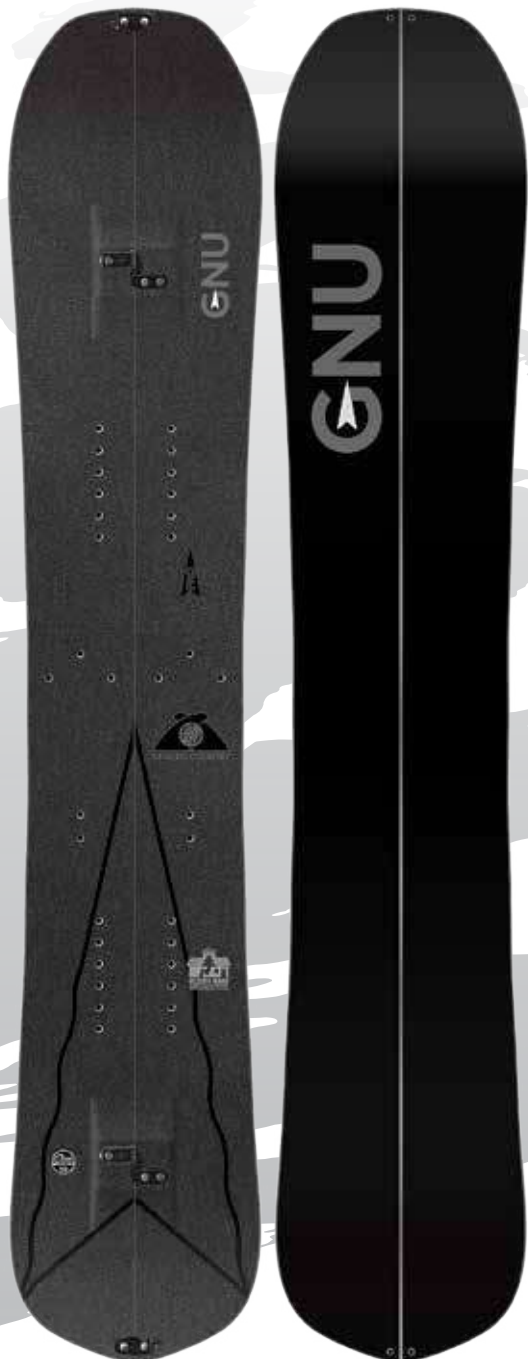

UNISEX

ALL MOUNTAIN FREERIDE / DIRECTIONAL SPLIT BOARD

- Temple and Cannon's lightweight directional pow slayer split
- Pillows, steeps and everything else out there
- Progressive Magne-Traction®, Karakoram Ultra Clips, and Carbon Power Bands for radical response and pop

Art: Gnu Art Store
@gnusnowboards



Temple and Cannon's Banked Country split is a magical metamorphosis...their refined resort carving pow slaying machine has transformed into a lightweight climbing, powder and adrenalin access tool. A radically refined directional geometry/shape that includes a floaty nose, mild taper, Banked Slalom winning side cut and their unique Progressive "teeth in the tail" Magne-Traction® for quiet turn entry and unbelievable hook up in the tail to finish. A lightweight Paulownia core make this an effortless climber and floaty smooth rider. Karakoram Ultra Clips lock it all together for a solid board feel and speedy smooth transitions. Highly refined, heavily tested by the boys and you know this is the right stick when you are in Banked Country.

TERRAIN TYPES



RIDER ABILITY



FLEX SCALE



Aggressive All Terrain Contour



- CORE:** FSC Certified 95% Paulownia with Aspen structure beams
- GLASS:** Tri-Ax/Bi-Ax with carbon power bands and insert reinforcement
- TOP:** Eco-Sublimated Poly Top: Tough And Environmentally Nice
- BASE:** Sintered Knife-Cut: Fast, Tough And Holds Wax
- SIDEWALLS:** UHMW: Tough And Fast
- TIP/TAIL:** Ultralight thin tip UHMW

LENGTH	CONTACT LENGTH	SIDE CUT	NOSE WIDTH	WAIST WIDTH	TAIL WIDTH	STANCE MIN-MAX/SET BACK
155	112 cm	8.2	29.4	25.3	29.2	19"- 24"/ 1.5"
159	114 cm	8.3	29.6	25.4	29.4	20"- 25"/ 1.5"
162	116 cm	8.4	29.8	25.5	29.6	20"- 25"/ 1.5"



FREESTYLE / PARK

MONEY
TWIN SHAPE



HYBRID C2
GLITE1
MAGNE-TRACTION

- 130 ww* 23
- 135 ww* 23.2
- 140 ww* 23.4
- 144 ww* 24.2
- 148 ww* 24.7
- 152 ww* 25.3
- 154 ww* 25.4
- 156 ww* 25.5
- 159 ww* 25.6
- WIDES
- 150 ww* 26
- 154 ww* 26.2
- 158 ww* 26.6

Art: Jay Howell
@punksitcut

C MONEY
TWIN SHAPE



CAMBER
GLITE1
MAGNE-TRACTION

- 144 ww* 24.2
- 148 ww* 24.7
- 152 ww* 25.3
- 154 ww* 25.4
- 156 ww* 25.5
- 159 ww* 25.6
- WIDES
- 150 ww* 26
- 154 ww* 26.2
- 158 ww* 26.6

Art: Jay Howell
@punksitcut

HEAD SPACE By Forest Bailey
TWIN SHAPE



CAMBER
GLITE2
MAGNE-TRACTION

- 149 ww* 25
- 152 ww* 25
- 155 ww* 25.4
- 158 ww* 25.5
- WIDES
- 155 ww 26.4

Art: Forest Bailey
@forestbailey

25
MENS
26



RECESS PACKAGE
TWIN SHAPE



Youth Small Package
80 ww* 20.0
90 ww* 21.0
100 ww* 21.0



Including
Speed Strap Binding

Youth Medium/Large
Package
110 ww* 22
120 ww* 22.5
125 ww* 22.7



Including
Traditional Binding

FACTS
DIRECTIONAL TWIN



HYBRID C2
GLITE1
MAGNE-TRACTION

- 147 ww* 24.2
- 150 ww* 24.5
- 153 ww* 24.8
- 156 ww* 25.4
- 159 ww* 25.5
- WIDES
- 156 ww* 26.7
- 159 ww* 26.7
- 162 ww* 26.7

Art: Gnu Art Dept.
@gnusnowboards

FINEST - By Max Warbington
ASYM TWIN SHAPE



HYBRID C2
GLITE2
MAGNE-TRACTION

- 148 ww* 24.8
- 151 ww* 25
- 154 ww* 25.1
- 157 ww* 25.5
- 159 ww* 25.7
- WIDES
- 155 ww* 26.2

Art: Max Warbington
@69max420

RIDERS CHOICE
ASYM TWIN SHAPE



AC ASYM CHIPS
HYBRID C2
GLITE3 CARBON

MAGNE-TRACTION

MAGNE-TRACTION

- 151.5 ww* 25.1
- 154.5 ww* 25.2
- 157.5 ww* 25.5
- 159.5 ww* 25.6
- 161.5 ww* 25.8
- WIDES
- 155 ww* 26.5
- 158 ww* 26.8
- 162 ww* 26.8

Art: TREVOR YARDLEY-JONES
@trevorj

WAGYU - By Cannon Cummins
DIRECTIONAL TWIN SHAPE



CAMBER
GLITE2
MAGNE-TRACTION

- 155 ww* 25.3
- 158 ww* 25.5
- 161 ww* 25.7

Art: Jayden Chomick
@jadychomick

YOUTH FREESTYLE / ALL MOUNTAIN

Art: Hannah Eddy
@hannahedyart

FREESTYLE / ALL MOUNTAIN

ANTIGRAVITY
DIRECTIONAL SHAPE



CAMBER
GLITE1
MAGNE-TRACTION

TEXTURED TOP SHEET

- 150 ww* 25
- 153 ww* 25.2
- 156 ww* 25.5
- 159 ww* 25.7
- 162 ww* 25.8
- WIDES
- 159 ww* 26.7
- 162 ww* 26.8

Art: Shawn Bishop
@shawnbsh

GREMLIN
DIRECTIONAL SHAPE



CAMBER
GLITE2
MAGNE-TRACTION

- 144 ww* 25.5
- 148 ww* 25.8
- 152 ww* 26.1
- 155 ww* 26.4
- 158 ww* 27
- 161 ww* 27.5

Art: Gnu Art Dept.
@gnusnowboards

UPGRADE
DIRECTIONAL TWIN HYBRID



HYBRID C2
GLITE2
UPGRADED CARBON BASE

- 151 ww* 25.1
- 153 ww* 25.3
- 156 ww* 25.5
- 159 ww* 25.7
- WIDES
- 157 WW* 26
- 160 WW* 26.5

Creative vision
Jeff Henderson
@jeffhendo

4x4 By Forest Bailey
DIRECTIONAL SHAPE



CAMBER
GLITE2
MAGNE-TRACTION

- 157 ww* 25.5
- 160 ww* 25.7

Art: Forest Bailey
@forestbailey

SOMETHING GNU
ALL MOUNTAIN FREERIDE/DIRECTIONAL SHAPE



HYBRID C2
GLITE3 CARBON

MAGNE-TRACTION

- 151 ww* 25
- 156 ww* 25.3
- 161 ww* 26.1
- 169 ww* 26.5

Creative vision
Pete Saari
@turletater

BANKED COUNTRY
DIRECTIONAL SHAPE



CAMBER
GLITE3 CARBON
PRO MAG

- 155 ww* 25.3
- 159 ww* 25.4
- 162 ww* 25.5
- WIDE
- 160 ww* 26.5
- 163 ww* 26.5

Art: Temple Cummins
@templecummins

ALL MOUNTAIN

FREESTYLE / PARK

GLOSS TWIN SHAPE



HYBRID C2
GLITE 1
MAGNE-TRACTION

136 ww* 22.6
140 ww* 23.3
144 ww* 23.5
148 ww* 23.9
waist width*

Art: Sara Phillips
@sphilips

GLOSS C TWIN SHAPE



CAMBER
GLITE 1
MAGNE-TRACTION

136 ww* 22.6
140 ww* 23.3
144 ww* 23.5
148 ww* 23.9
waist width*

Art: Sara Phillips
@sphilips

25 WOMENS 26



RECESS PACKAGE TWIN SHAPE



Youth Small Package
80 ww* 20.0
90 ww* 21.0
100 ww* 21.0
waist width*

Including
Speed Strap Binding

Youth Medium/Large Package
110 ww* 22
120 ww* 22.5
125 ww* 22.7
waist width*

Including
Traditional Binding

FICTION DIRECTIONAL TWIN



HYBRID BANANA
GLITE 1
MAGNE-TRACTION

133 ww* 22.5
139 ww* 22.6
142 ww* 23.2
145 ww* 23.4
148 ww* 24
151 ww* 24.3
154 ww* 24.6
waist width*

Art: Gnu Art Dept.
@gnusnowboards

VELVET TWIN SHAPE



HYBRID C2
GLITE 2
MAGNE-TRACTION

139 ww* 22.6
143 ww* 23.5
147 ww* 24
150 ww* 24.3
153 ww* 24.6
waist width*

Art: Hannah Eddy
@hannahedydyart

LADIES CHOICE ASYM TWIN SHAPE By Jamie Anderson



HYBRID C2
ASYM
GLITE 3 CARBON
MAGNE-TRACTION

139.5 ww* 22.6
142.5 ww* 23.2
145.5 ww* 24
148.5 ww* 24.2
151.5 ww* 24.4
153.5 ww* 24.4
waist width*

Art: Sarah King
@sarahkingart

LADIES CHOICE CAMBER ASYM TWIN SHAPE By Jamie Anderson



CAMBER
ASYM
GLITE 3 CARBON
MAGNE-TRACTION

145.5 ww* 24
148.5 ww* 24.2
151.5 ww* 24.4
waist width*

Art: Sarah King
@sarahkingart

YOUTH FREESTYLE / ALL MOUNTAIN

Art: Hannah Eddy @hannahedydyart

FREESTYLE / ALL MOUNTAIN

FROSTING DIRECTIONAL SHAPE



HYBRID C2
GLITE 2
MAGNE-TRACTION

143 ww* 24
146 ww* 24.1
149 ww* 24.3
152 ww* 24.4
waist width*

Art: Naima Antolin
@naimaantolin

BARRETT By Barrett Christy
DIRECTIONAL SHAPE



CAMBER
GLITE 3 CARBON
PROMAG

B4BC
Portion of sales benefits

146 ww* 24.1
149 ww* 24.3
152 ww* 24.5
155 ww* 24.8
waist width*

Art: Ryder Biolos
@rartbyryder

FREE SPIRIT By Jamie Anderson
DIRECTIONAL SHAPE



CAMBER
GLITE 3 CARBON
MAGNE-TRACTION

148 ww* 25.5
153 ww* 25.5
waist width*

Art: Sarah King
@sarahkingart

BANKED COUNTRY SPLITS DIRECTIONAL SHAPE



CAMBER
PROMAG

SPLIT CONSTRUCTION
155 ww* 25.3
159 ww* 25.4
162 ww* 25.5
waist width*

Art: Gnu Art Dept.
@gnusnowboards

ALL MOUNTAIN

ALL MOUNTAIN SPLIT BOARD
By Temple & Cannon Cummins

MENS & WOMENS

25 | *GNU* | 26
SNOWBOARDS

EARLY RELEASE

SOMETHING GNU
ALL MOUNTAIN FREERIDE/DIRECTIONAL SHAPE

NEW! **WAGYU** - By Cannon Cummins
DIRECTIONAL TWIN SHAPE



HYBRID
C2 DIRECTIONAL

GLITE 3
CONSTRUCTION
CARBON

MAGNE-TRACTION
EDGE HOLD ADVANTAGE

151 ww* 25
156 ww* 25.3
161 ww* 26.1
169 ww* 26.5
waist width*

Creative vision
Pete Saari
@turtletater



C³ CAMBER

GLITE 2
CONSTRUCTION

MAGNE-TRACTION
EDGE HOLD ADVANTAGE

155 ww* 25.3
158 ww* 25.5
161 ww* 25.7
waist width*

Art: Jady Chomlack
@jadychomlack



Gnu

SPEED/IN

FASTER / EASIER / SMARTER

UNIVERSAL & DUAL ENTRY

25/26

UNIQUE TECHNOLOGY

Reclining Highback - Rear Entry Advantage

Auto Open Ankle Strap - Opens Auto *MAGICALLY!*

Auto Lever - Simplified Entry

Cable Redirection - Unimpeded Movement

Lifetime Baseplate Warranty

Gnu's unique speed entry binding system is the ultimate in performance, speed, ease and comfort. Fits any snowboard boot. Set your bindings up once and one lever gets you in and out with amazing ease all season long. Enjoy more time riding and smiling and less time fiddling and sitting. Hit the pressure release button in the lift line for max comfort and circulation as you float up to the top for another epic run... Unreal Bindings!

HOW TO SPEED/IN



SPEED ENTRY BINDING SYSTEM
FASTER, EASIER, SMARTER



Lightweight,
performance and
strength in an
incredibly fast
binding system!

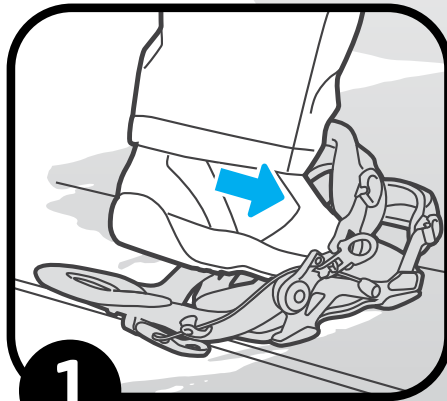

1 SPEED In



2



3

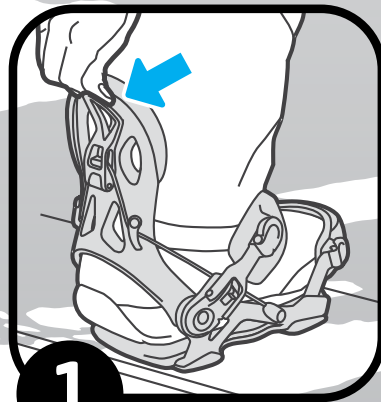

1 SPEED Out

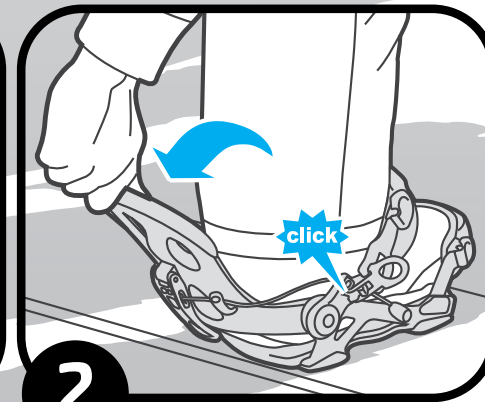

2

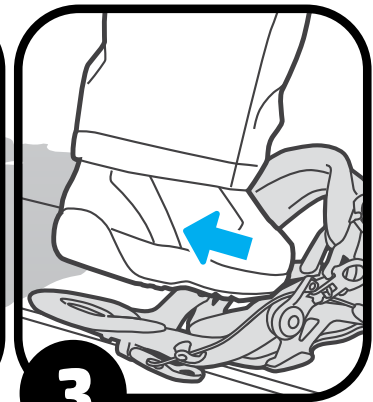

3



UNIQUE/KEY TECHNOLOGY

Duplex Ankle Strap

- Ultra-light.
- Flip strap to change flex response.
- Two Straps in one

Strategically cored single injection construction is made with pliable TPU creating a comfortable and lightweight strap. Flip-able design enables a soft or stiff response for rider customization. Softer flexing side has extra large coring and smaller surface area. Stiffer flexing side has reduced coring and taller surface to lean into for more response.

CORE TECHNOLOGY BENEFIT	BENEFIT - Concise	BENEFIT - Description
Reclining Highback	Rear Entry Advantage	Makes enter and exit incredibly fast and easy, with one hand.
Auto Open System	Works like Magic. Opens Auto-"Magically"	Upper strap opens auto-"magically"when highback reclines for a quick, easy and extra large entry and exit zone.
Auto Lever	Simplified Entry	Only one click to apply the right amount of pressure. No more fumbling with ratchet buckles.
Pressure Relief Button	Warm, Happy Feet	Can be pressed manually to relax ankle strap pressure on front after run while boots remains secure in binding. Increased blood flow keeps feet comfortable and warm.
Ankle Strap - Micro Buckle	Quickly Adjust Tension	Rider can adjust strap tension while on the go. Tighten a couple clicks for a big hit or loosen for different terrain. Release strap for additional exit and entry space in steep terrain.
Ankle & Toe Strap - Micro Buckle	Multi-Entry Option	Micro Buckles on both straps enable you to open and close both straps in traditional way in case you need that option.
Cable Redirection	Unimpeded Movement	Ensures maximum freedom of movement of boot. Reduces strain when closing highback.
Toe Cup Wrap Strap	Precision Fit and Response	Secures boot in place for a perfect fit each time. Wrap design provides more support and response while eliminating wedge and cinch pressure.
Highback Rotation	Custom Support	Highbacks can be rotated laterally to find the custom support angles that work for your style of riding.

CHEETER

SPEED/IN
MENS

PULL A FAST ONE AND BEAT THE CROWD

- FT4 Baseplate - Predictable Performance
- ERGO-X Highback - Smoother entry and exit
- Thin Fit Toe strap - Ultra thin and light, wraps like second skin

On top of the innovative speed entry technology, asymmetric highbacks add support to your natural riding stance for control while the FT-4 Nylon Baseplate provides a smooth ride and vibration absorption for a full riding days comfort.

RESPONSE: RELAXED / ALL AROUND / AGGRESSIVE
RIDING STYLE: ALL MOUNTAIN

S (US M 4-7), M (US M 7-10), L (US M 10-12), XL (US M 12-14)

Disk: 4x4, Channel. Fiber Reinforced Polymer

Colorways: Black and White

4/10
FLEX



BLACK



WHITE



PSYCH

SPEED/IN
MENS

ULTRA-LIGHT FREESTYLE MOBILITY AND QUICKNESS TO BLOW YOUR MIND

- Hyper Cored Aluminum Baseplate - Light & Responsive
- ERGO-X Highback - Smoother entry and exit
- Complex Toe Cup Strap with Micro Buckle - Oversize with soft textiles and foam
- Canting

Not only do you get in and out of your bindings faster, the ultra-light aluminum chassis and highback enable you to maneuver quicker with less fatigue. The asymmetric highback design allows mobility to get out over you board and support to ride away clean. This combo is forgiving in freestyle terrain and flows on mountain.

RESPONSE: RELAXED / ALL AROUND / AGGRESSIVE

RIDING STYLE: ALL MOUNTAIN - FREESTYLE

S (US M 5-7), **M** (US M 7-9), **L** (US M 9-11), **XL** (US M 12-14)

Disk: 4x4. Fiber Reinforced Polymer

Colorways: Black and White

6/10
FLEX



WHITE



BLACK



FREEDOM

SPEED/IN
MENS

BREAKOUT ON THE POWER AND SPEED MACHINE

- Hyper Cored Baseplate with extra footbed dampening and a heel shock pod
- Alu Heelcup reinforced highback for response and precision at speed
- Canting

Extra supportive ankle straps and responsive highback with aluminum heelcup for riding in turbo mode. The aluminum chassis is ultra-light and sensitive for precision input in advanced terrain. Heel shock pads and a chassis enveloped by an EVA pad smooth out the shocks and vibration from hard landings and firm terrain.

RESPONSE: RELAXED / ALL AROUND / AGGRESSIVE

RIDING STYLE: ALL MOUNTAIN

M (US M 7-9), **L** (US M 9-11), **XL** (US M 12-14)

Disk: 4x4, Channel. Forged Aluminum

Colorway: Black

8/10
FLEX



BLACK

B♥REAL

SPEED/IN
WOMENS

DO MORE OF WHAT YOU CAME FOR

- FT4 Baseplate - Predictable Performance
- ERGO-X Highback - Smoother entry and exit
- Thin Fit Toe strap - Ultra Thin and light, wraps like second skin.

In addition to the practical speed-entry system you will become one with your binding supported by Asymmetric Highbacks that duplicate a natural riding stance and the predictable, smooth ride of the FT-4 Nylon Baseplate.

RESPONSE:  **RELAXED** / ALL AROUND / AGGRESSIVE

RIDING STYLE: ALL MOUNTAIN

S (US W 5-7), **M** (US W 7-9), **L** (US W 9-11)

Disk: 4x4, Channel. Fiber Reinforced Polymer

Colorway: White

4/10
FLEX



WHITE

FANTAST

SPEED/IN
WOMENS

LEAVE THE CROWD BEHIND AND RIDE

- Hyper Cored Aluminum Baseplate - Light & Responsive
- ERGO-X Highback - Smoother entry and exit
- Comprex Toe Cup Strap with Micro Buckle - Oversize with soft textiles and foam

An aluminum chassis provides feedback to navigate with precision while the lightweight attributes increases response and reduces fatigue. Enveloped in a supportive ankle strap with a compression window for max comfort the full EVA wrapped footbed with large heel shock pad keeps your feet happy all day long.

RESPONSE: RELAXED / ALL AROUND / AGGRESSIVE

RIDING STYLE: ALL MOUNTAIN - FREESTYLE

S (US W 5-7), **M** (US W 7-9), **L** (US W 9-11)

Disk: 4x4. Fiber Reinforced Polymer

Colorway: Black

6/10
FLEX



MENS



BLACK



WHITE



WHITE



BLACK



BLACK

Grü

SPEED/IN

FASTER / EASIER / SMARTER

UNIVERSAL & DUAL ENTRY

25/26

CHEETER →

PSYCH

⇄ **FREEDOM** ⇄

WOMENS



WHITE



BLACK

B♥REAL

FANTAST

GNU SCIENCE EXPLAINED



MAGNE-TRACTION®
EDGE HOLD ADVANTAGE
THE ORIGINAL SERRATED STEAK KNIFE TECHNOLOGY



MAGNE-TRACTION®
DEEPEST SERRATIONS BETWEEN THE FEET
MILD SERRATION
ENTRY SERRATION

7 SERRATED STEAK KNIFE TECHNOLOGY
7 strategically located and sized edge serrations provide unreal edge hold and control in all conditions.



PRO MAG
A CUMMINS FAMILY EXCLUSIVE TEETH IN THE TAIL!

DIRECTIONAL SERRATED EDGE TECH
TEETH IN THE TAIL!
Combination of radial entry side-cut and strategically located edge serrations provide smooth entry and powerful "fin like" edge hold in the tail.



AWESOME TURNING
ASYM AWESOME
BALANCE THROUGH ASYMMETRY



- Precision control
- Steeper activation angle



- Power
- Lower activation angle



ASYM CHIPS
3-D Delightwood Asym Chip
Riders Choice

ASYM Asym Sidecut & Contact

ASYM Sidecut: Deeper sidecut on heelside (power side).

ASYM Contact: Asymmetric contact angles longer toe side contact (finesse side) and shorter heelside contact (power side).

MENS Riders Choice / Finest

WOMENS Pro Choice / Ladies Choice CAMBER

GNU SCIENCE EXPLAINED

GLITE CONSTRUCTION

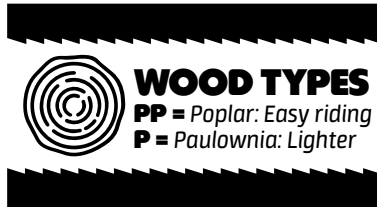

G LITE 1

CORE: FSC Certified Poplar + Paulownia Core Light, Strong And Poppy
GLASS: Tri-Ax/Bi-Ax Glass | **TOP:** Eco Sublimated Poly Top | **BASE:** Eco Sublimated Co-Ex Base
SIDEWALL & TIPS/TAILS: UHMW

MENS: Money / C MONEY / Facts / Antigravity

WOMENS: Gloss / Gloss C / Fiction



G LITE 2

CORE: FSC Certified Aspen + Paulownia Core Light, Strong And Poppy
GLASS: Tri-Ax/Bi-Ax Glass | **TOP:** Eco Sublimated Poly Top | **BASE:** Sintered Base
SIDEWALL & TIPS/TAILS: UHMW

MENS: Finest / Head Space / 4x4 / Gremlin / Wagyu / Upgrade

WOMENS: Velvet / Frosting

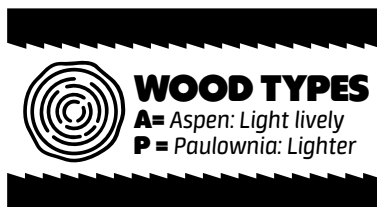

G LITE 3 CARBON

CORE: FSC Certified Aspen + Paulownia Core Lightest, Stronger And Most Poppy
GLASS: Tri-Ax/Bi-Ax Glass + Carbon Power Bands | **TOP:** Eco Sublimated Poly Top or Bio Beans (Jamie Anderson pro models)
BASE: Sintered Base | **SIDEWALL & TIPS/TAILS:** UHMW

||| CABON POWER BANDS Add pop, response and extend board performance life

MENS: Riders Choice / Banked Country / Something GNU

WOMENS: Ladies Choice / Ladies Choice Camber / Barrett / Free Spirit

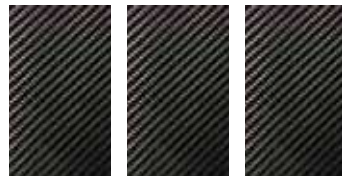

GNU SCIENCE EXPLAINED

CONTOURS BANANA IS TECHNOLOGY

BNA

THE ORIGINAL ROCKER/CAMBER HYBRID CONTOURS. UNREAL CONTROL.
PATENT #7823892 #8511704

ENGINEERED FOR SNOWBOARDING:

- Full contact and control in all conditions
"Awesome Everywhere"

ROCKER BETWEEN YOUR FEET / CAMBER OUTSIDE OF YOUR FEET.

- Central rocker builds in carve, edge hold and float
- Outboard camber builds in pop, stability and control

Performance hybrid bottom contours engineered for snowboarding. Snowboarding is done with two feet on one board in a sideways stance. Banana Technology combines mild rockers between your feet with varying amounts of camber to the contact points to maximize edge contact, control and hold in a sideways stance. The rocker brings to life the middle of your board that, with traditional ski camber is a low pressure "dead zone", while also adding float, improving carving and power. The cambers out to the tip and tail fine tune the pressure map, add pop, tip and tail stability, precision and control.

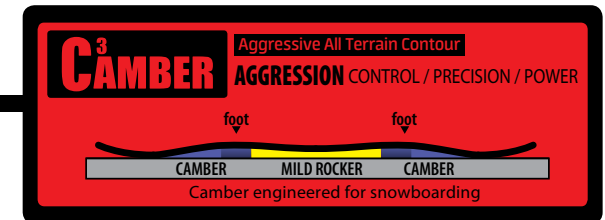
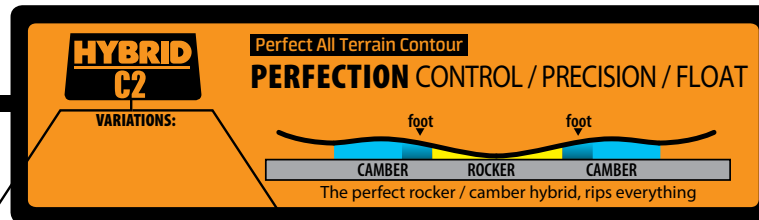
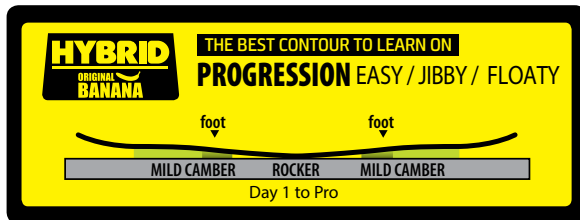
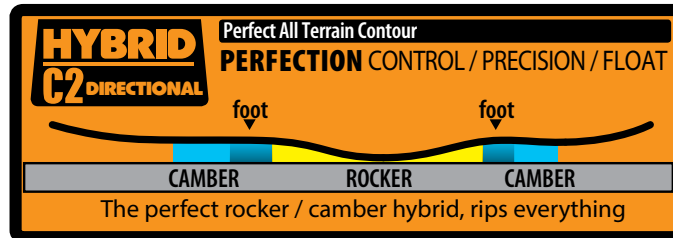

HYBRID C2'

Easy Riding
All Terrain Contour

HYBRID C2'

Xtreme Riding
All Terrain Contour

25 | *Gnu* | 26
SNOWBOARDS

